

SHANK PROFILE

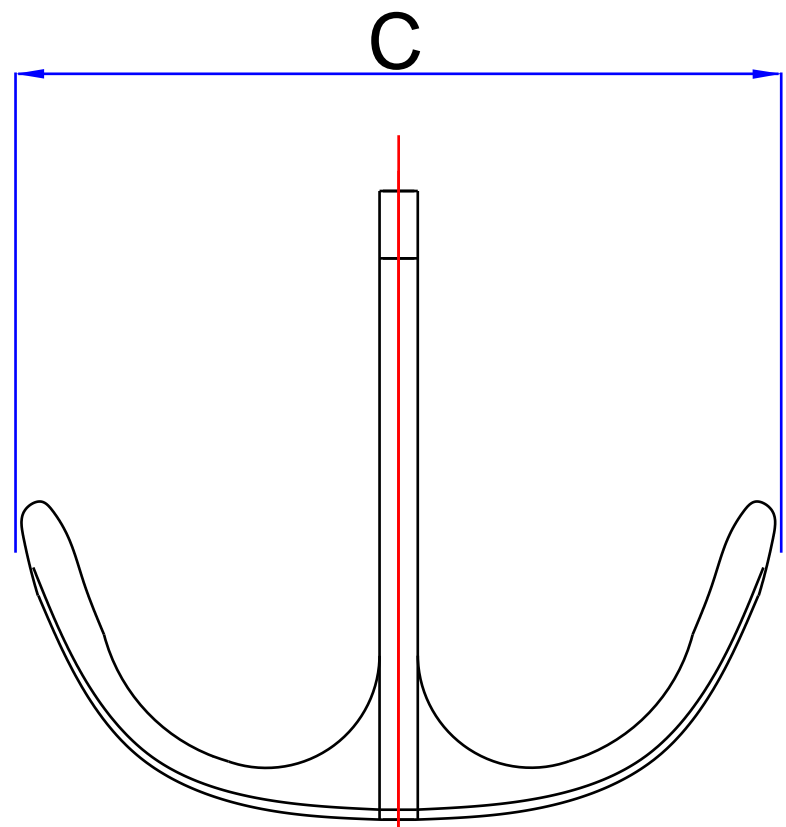

FLUKE PROFILE

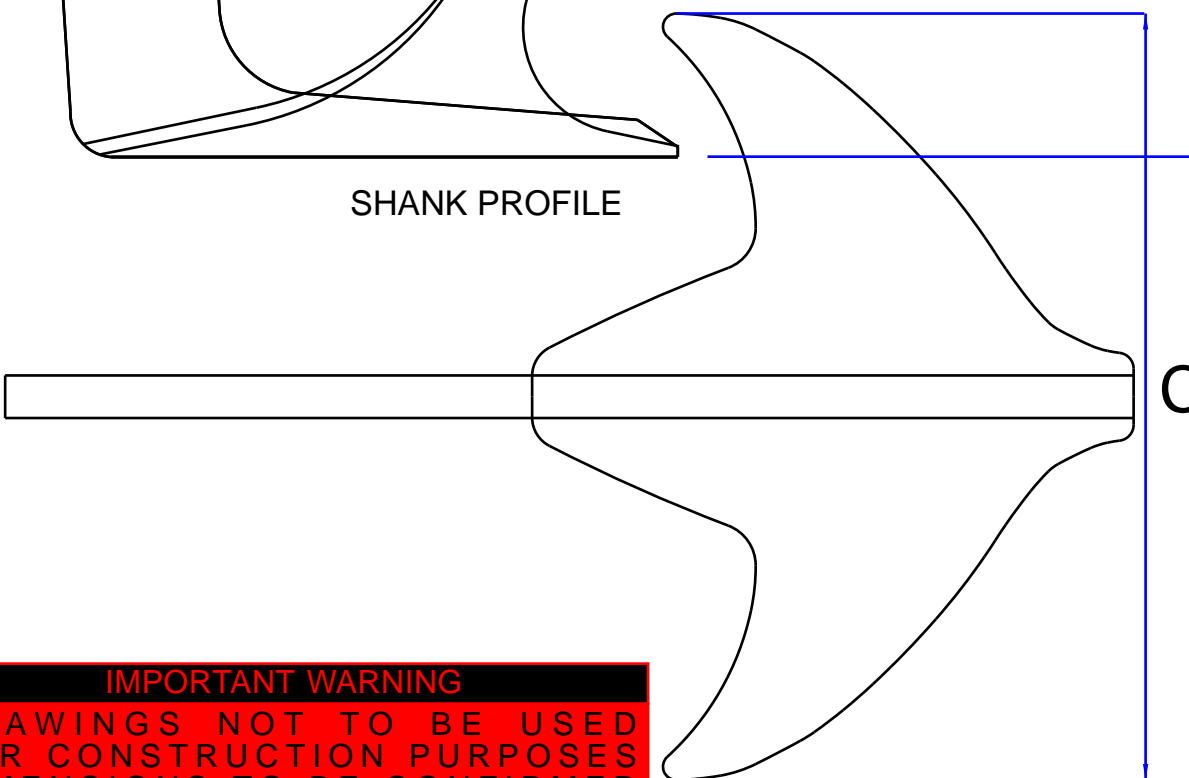

PLAN VIEW

RAY ANCHOR DIMENSIONS (inches)			
KG	A	B	C
10	22 1/2	12 1/2	15 1/4
15	26 3/4	15	17 1/2
20	28	15 3/4	18 1/4
25	28	15 3/4	18 1/4
30	32	18	21 1/4
40	33 3/4	19	23 1/4
50	36 3/4	20 3/4	25 1/4
80	41 3/4	23 1/2	28
100	44 3/4	25	30 1/2
120	48	27	32 3/4
150	53 1/4	27 1/4	35
CUSTOM SIZING UP TO 600kg (1300lbs)			
PLEASE CONTACT FOR DIMENSIONS			

RAY ANCHOR DIMENSIONS (mm)			
KG	A	B	C
10	570	320	390
15	680	380	445
20	710	400	465
25	710	400	465
30	810	455	540
40	860	485	590
50	935	525	640
80	1060	595	710
100	1135	635	775
120	1220	685	835
150	1350	695	890
CUSTOM SIZING UP TO 600kg (1300lbs)			
PLEASE CONTACT FOR DIMENSIONS			

IMPORTANT WARNING
 DRAWINGS NOT TO BE USED
 FOR CONSTRUCTION PURPOSES
 DIMENSIONS TO BE CONFIRMED
 BY MANSON BEFORE ORDERING

	MANSON ANCHORS RAY ANCHOR FOR SIZING SEE TABLE		
	<small>MATERIALS: PIN SAF 2205 STAINLESS STEEL 316L</small>	<small>DATE: 25/11/04</small>	<small>DRAWN: Manson</small>
<small>DIMENSIONS in mm tolerances +/- 0.3 unless otherwise stated</small>	<small>SCALE: 1:75 @ A4</small>	<small>FILE: ANCHORS-00</small>	<small>SHEET: 1 of 1</small>
<small>CHECKED:</small>	<small>DWG No: Man-Gen</small>	<small>REVISION: 0</small>	